

REVISIONS		
#	DATE	DESCRIPTION

**MIDDLESEX SCHOOL  
FACULTY HOUSING**

 **Middlesex**  
1400 Lowell Road  
Concord, MA 01742

**cbt** 617 262 4354 cbtarchitects.com  
110 canal street boston, ma 02114

**ARCHITECT**  
**CBT**  
110 Canal Street  
Boston, MA 02114  
p. 617 262 4354, f. 617 267 9667

**CIVIL ENGINEER**  
**NITSCH ENGINEERING**  
2 Center Place #430  
Boston MA, 02108  
p. 617 338 0063

**STRUCTURAL ENGINEER**  
**LE MESSURIER**  
1380 Soldiers Field Road  
Boston, MA 02135  
p. 617 868 1200

**MEP-FP/ CODE**  
**(C3) COMMERCIAL CONSTRUCTION  
CONSULTING, INC.**  
313 Congress Street  
Boston, MA 02210  
p. 617 530 1471, f. 617 330 9383

**RESIDENTIAL PRE-FABRICATOR**  
**HUNTINGTON HOMES, INC.**  
344 Fassett Road  
East Montpelier, VT 05651  
p. 802 479 3625, f. 802 479 0575

- D100's - Demolition Drawings
- D200's - Demolition Ceiling PLANS
- D300's - Demolition Elevations
- A100's - Floor Plans
- A200's - Building Elevations
- A300's - Building/ Wall Sections
- A400's - Vertical Circulation
- A500's - Furniture Plans
- A600's - Ceiling Plans
- A700's - Finish Plans & Enlarged Plans
- A800's - Enlarged Food Service Plans
- A900's - Interior Details
- AS100's - Slab Plans

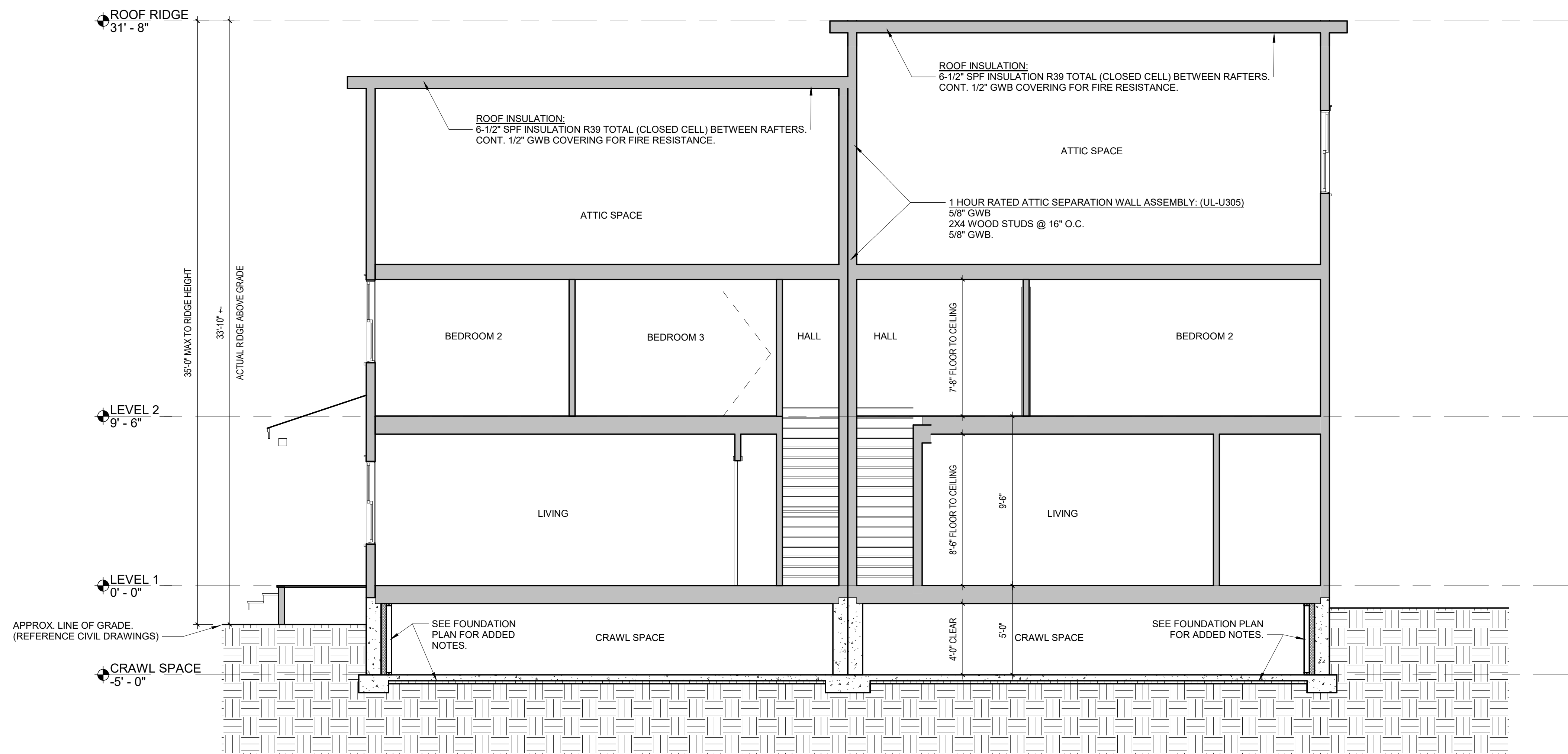

**2** DUPLEX - BUILDING SECTION  
1/4" = 1'-0"

**BUILDING SECTION**

SCALE 1/4" = 1'-0" PROJECT # 207078.00 DATE ISSUED 1.14.2022

**A300**

1/18/2022 1:46:10 PM