

TEC RECOMMENDATIONS:

1. THE BIKEWAY CROSSING LOCATION REQUIRES COMPATIBILITY WITH ADA/AAB ACCESSIBLE RAMPS DUE TO EXISTING SIDEWALKS ALONG HANCOCK STREET. WITH A NEED FOR THE BIKEWAY TO ENTER THESE RAMPS AS CLOSE TO PERPENDICULAR AS POSSIBLE, TEC RECOMMENDS UTILIZING SMALLER 30-FOOT BIKEWAY CENTERLINE RADII AT EACH ENTERING APPROACH. WHILE THE MASSDOT PPDG RECOMMENDS MINIMUM 36-FOOT RADII (12 MPH DESIGN SPEED), OTHER BIKEWAYS, SUCH AS THE BRUCE FREEMAN RAIL TRAIL, DO INCLUDE SLIGHTLY SMALLER RADII OF 30-FEET.
2. THE BIKEWAY CROSSING ALSO SERVES AS A PEDESTRIAN CROSSING. THE RECOMMENDED, MORE PERPENDICULAR, REALIGNMENT INCREASES SAFETY FOR VISUALLY IMPAIRED PEDESTRIANS USING THE CROSSWALK.
3. TEC RECOMMENDS THAT THE TOWN OF LEXINGTON CONSIDER INSTALLATION OF AN RRFB ASSEMBLY AT THIS LOCATION DUE TO THE LIMITED AMBIENT LIGHTING, PROXIMITY TO THE HARRINGTON ROAD AND BEDFORD STREET INTERSECTION, AND THE RESTRICTED VISIBILITY OF CYCLISTS AND PEDESTRIANS USING THE PATH BY APPROACHING VEHICLES.
4. TEC RECOMMENDS THAT THE TOWN OF LEXINGTON CONSIDER INSTALLING DECORATIVE BOLLARDS, OR SIMILAR INFRASTRUCTURE, TO DENOTE CROSSING LOCATION ALONG BIKEWAY.

IDENTIFICATION NUMBER	SIZE OF SIGN (in)		LEGEND	COLOR		
	WIDTH	HEIGHT		BACK-GROUND	LEGEND	BORDER
R1-1	36	36		RED	WHITE	WHITE
R5-3	24	24		WHITE	BLACK	BLACK
R10-25	9	12		WHITE	BLACK	BLACK
W11-15	30	30		FLUOR. YELLOW/GREEN	BLACK	BLACK
W11-15p	24	18		FLUOR. YELLOW/GREEN	BLACK	BLACK
W16-7pL	24	12		FLUOR. YELLOW/GREEN	BLACK	BLACK
W16-7pR	24	12		FLUOR. YELLOW/GREEN	BLACK	BLACK
W16-9p	24	12		FLUOR. YELLOW/GREEN	BLACK	BLACK

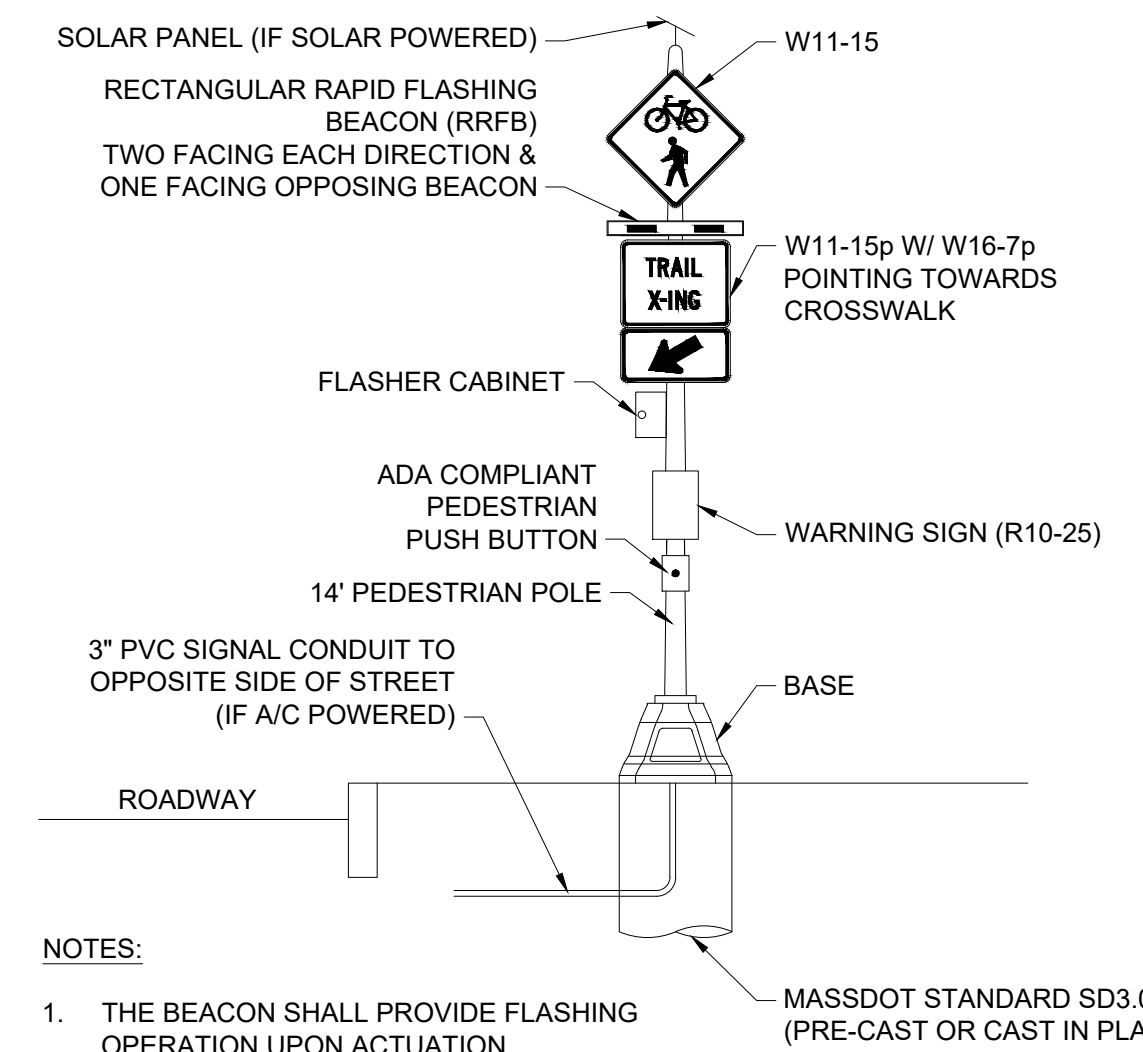

- NOTES:
1. THE BEACON SHALL PROVIDE FLASHING OPERATION UPON ACTUATION.
 2. FLASHING OPERATIONS SHALL COMPLY WITH SECTION 4L OF THE 2009 MUTCD.

RECTANGULAR RAPID FLASHING BEACON
N.T.S.

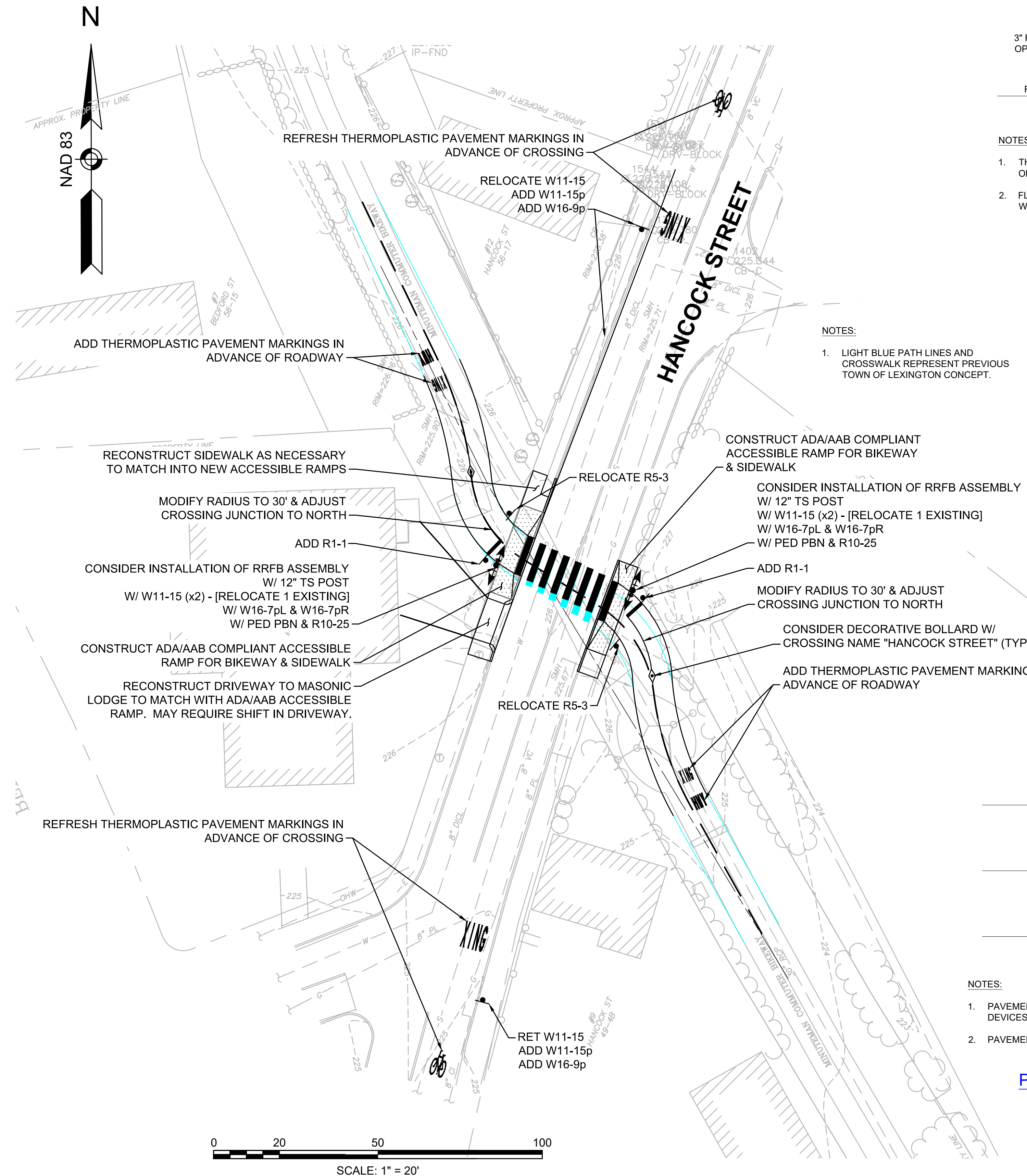

- NOTES:
1. LIGHT BLUE PATH LINES AND CROSSWALK REPRESENT PREVIOUS TOWN OF LEXINGTON CONCEPT.

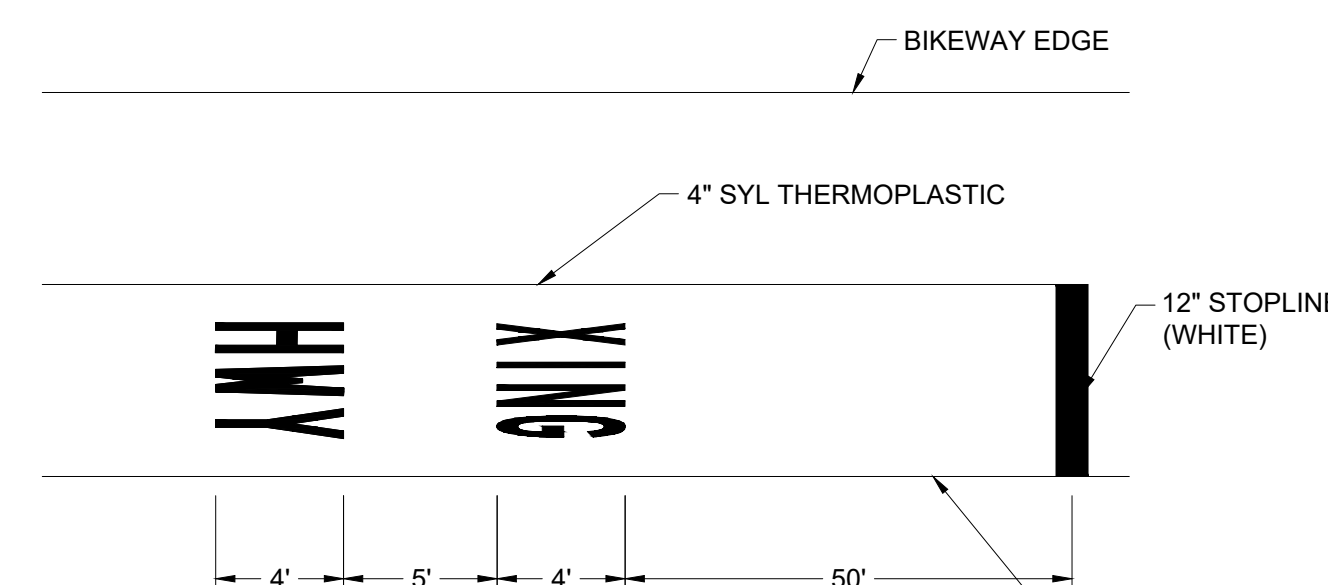

- NOTES:
1. PAVEMENT MARKINGS AS PER MANUAL ON UNIFORM TRAFFIC CONTROL DEVICES (MUTCD).
 2. PAVEMENT MARKINGS SHALL BE THERMOPLASTIC.

PAVEMENT MARKING ON BIKEWAY
N.T.S.